

# Round Inserts - Ribbed

Ideal tubing closures as furniture glides  
 Protects floor surfaces when used as feet  
 Ribbed for easy assembly and secure fitting

**strong**

**FLEXIBLE  
 PRODUCTION**

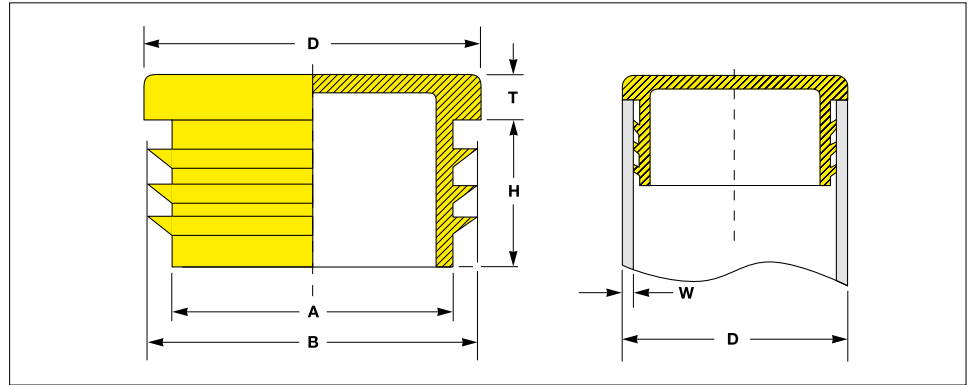

All dimensions in mm

Outside Dimension of Tube	Wall Thickness	A	B	H	T	Reference-No.
D	W					
10.0	1.0 - 2.0	2.8	9.2	10.1	3.5	GL 10 × 1.0 - 2.0
12.0	1.0 - 2.0	4.7	10.9	11.5	3.3	GL 12 × 1.0 - 2.0
13.0	1.0 - 2.0	5.6	12.2	11.5	3.7	GL 13 × 1.0 - 2.0
14.0	1.0 - 2.0	6.2	13.0	11.0	5.0	GL 14 × 1.0 - 2.0
15.0	0.8 - 2.0	7.2	14.3	11.5	4.4	GL 15 × 0.8 - 2.0
15.7	0.8 - 2.0	9.7	14.5	11.5	4.3	GL 16 × 0.8 - 2.0
18.0	0.8 - 2.0	12.5	17.1	11.5	4.4	GL 18 × 0.8 - 2.0
20.0	1.0 - 2.0	13.0	19.0	11.5	5.0	GL 20 × 1.0 - 2.0
22.0	1.0 - 2.0	15.0	21.2	11.5	4.8	GL 22 × 1.0 - 2.0
22.0	2.5 - 3.0	12.0	19.3	11.5	5.0	GL 22 × 2.5 - 3.0
23.0	1.0 - 2.0	17.0	21.5	11.5	5.0	GL 23 × 1.0 - 2.0
25.0	1.0 - 2.0	17.6	24.0	11.5	5.0	GL 25 × 1.0 - 2.0
25.0	2.5 - 3.5	17.0	21.9	11.5	5.0	GL 25 × 2.5 - 3.5
26.0	1.0 - 2.0	18.0	24.5	11.5	5.0	GL 26 × 1.0 - 2.0
27.0	1.0 - 2.0	20.0	26.9	11.5	4.8	GL 27 × 1.0 - 2.0
28.0	1.0 - 2.0	20.0	27.0	11.2	5.0	GL 28 × 1.0 - 2.0
30.0	1.0 - 2.0	23.0	28.7	11.5	4.8	GL 30 × 1.0 - 2.0
32.0	1.0 - 2.0	25.0	30.9	11.5	4.8	GL 32 × 1.0 - 2.0
34.0	1.0 - 3.0	26.8	32.5	11.5	4.8	GL 34 × 1.0 - 3.0
34.0	3.0 - 3.5	26.0	28.4	11.5	5.0	GL 34 × 3.0 - 3.5
34.0	3.5 - 4.0	22.0	28.7	11.8	4.8	GL 34 × 3.5 - 4.0
35.0	1.0 - 2.5	28.0	33.8	11.5	5.0	GL 35 × 1.0 - 2.5
36.0	1.0 - 2.0	28.1	34.9	11.5	4.8	GL 36 × 1.0 - 2.0
38.0	1.0 - 2.0	31.0	36.0	11.8	4.8	GL 38 × 1.0 - 2.0
40.0	1.0 - 2.0	32.9	39.3	11.8	4.8	GL 40 × 1.0 - 2.0
40.0	1.0 - 3.0	31.4	38.6	11.5	5.0	GL 40 × 1.0 - 3.0
42.0	1.0 - 2.0	35.5	41.2	11.5	4.9	GL 42 × 1.0 - 2.0
42.0	2.5 - 3.5	33.0	39.3	11.5	5.0	GL 42 × 2.5 - 3.5

**Material :**  
 LD-PE,  
 low density polyethylene

**Standard Colour :**  
 black

Ideal tubing closures as furniture glides. Protects floor surfaces when used as feet.

Ribbed for easy assembly and secure fitting.

Think Plastic. Go Protec.®

**PROTEC  
 PLASTICS**

Should your requirements not be shown please ask for a separate quotation.  
 PROTEC products and specifications are subject to improvement and change without notice.

# Round Inserts - Ribbed

Ideal tubing closures as furniture glides  
Protects floor surfaces when used as feet  
Ribbed for easy assembly and secure fitting

## TRIPLE ADVANTAGE of PROTEC CAPTOP®

**QUALITY.** Ideal tubing closures as furniture glides. Protects floor surfaces when used as feet. Ribbed for easy assembly and secure fitting.

**AVAILABILITY.** With over 400 million moulded components shipped from our UK logistics center we provide the fastest on time delivery service to all industries of the UK market.

**PHILOSOPHY.** Innovative protective closures at the best price in the market.



All dimensions in mm

Outside Dimension of Tube	Wall Thickness	A	B	H	T	Reference-No.
D	W					
45.0	1.0 - 2.0	37.3	43.2	11.5	5.0	GL 45 × 1.0 - 2.0
46.0	1.0 - 2.0	36.0	43.7	11.5	5.0	GL 46 × 1.0 - 2.0
48.0	1.0 - 2.5	40.0	46.0	14.5	5.0	GL 48 × 1.0 - 2.5
48.0	3.0 - 4.0	39.0	44.2	14.1	5.0	GL 48 × 3.0 - 4.0
50.0	1.0 - 2.0	43.0	49.3	11.5	4.7	GL 50 × 1.0 - 2.0
55.0	1.0 - 2.0	47.0	53.7	13.5	5.0	GL 55 × 1.0 - 2.0
60.0	1.5 - 3.0	48.0	57.8	17.0	4.0	GL 60 × 1.5 - 3.0
60.0	3.0 - 4.0	51.0	55.6	21.4	5.2	GL 60 × 3.0 - 4.0
70.0	2.0 - 4.5	59.0	67.0	21.0	5.0	GL 70 × 2.0 - 4.5
76.0	1.5 - 2.5	69.0	73.8	21.5	5.0	GL 76 × 1.5 - 2.5
76.0	3.0 - 4.0	66.0	71.6	21.5	5.0	GL 76 × 3.0 - 4.0
90.0	2.5 - 5.0	79.0	86.5	20.0	5.0	GL 90 × 2.5 - 5.0
102.0	2.0 - 4.0	92.0	98.7	20.0	5.0	GL 102 × 2.0 - 4.0
120.0	2.0 - 4.0	106.0	116.5	28.0	5.5	GL 120 × 2.0 - 4.0

Should your requirements not be shown please ask for a separate quotation.  
PROTEC products and specifications are subject to improvement and change without notice.

**Material :**  
LD-PE,  
low density polyethylene

**Standard Colour :**  
black

**Individual Productions :**  
On request we develop and produce individually tailored solutions next to the standard items of this range: additional dimensions, different materials and new colours

We would be pleased to advise you.

Think Plastic. Go Protec.®

**PROTEC**  
**PLASTICS**